

# THE Genesis™ BRACKET SYSTEM



**MASEL®**

# The Genesis Bracket System

The *Genesis* Active Self-Ligating Bracket System and the *Genesis-C™* Ceramic Active Self-Ligating Bracket System provide low-friction passive movement and controlled active sliding mechanics, as well as an advanced-technology durable clip for reliable and predictable treatment.

## Key features and benefits include:

- **Unique guide rail** for stability during clip opening and closing
- **Rounded Archwire slot** for enhanced sliding mechanics
- All brackets **open to the occlusal** to avoid tissue interferences
- **Vertical scribe line** aids in proper bracket placement along the long axis
- **Deep tie-wings** for easy optional ligation
- Interactive clip provides **passive** to **active** control for effective treatment



■ **Vertical scribe line** aids in proper bracket placement along the long axis

■ **Rounded Archwire slot** for enhanced sliding mechanics

■ Interactive clip provides **passive** to **active** control for effective treatment

■ **Unique guide rail** for stability during clip opening and closing

■ All brackets **open to the occlusal** to avoid tissue interferences

■ **Deep tie-wings** for easy optional ligation

## Genesis-C Ceramic Active Self-Ligating Bracket System

- **Made from Polycrystalline Alumina** material that blends perfectly with the natural tooth tone
- **Rhodium-coated clip** for aesthetics and reliable archwire changes
- **Ceramic Injection Molding (CIM)** results in complex structures that machined brackets cannot duplicate
- **Alumina coating** provides a patterned mechanical base for predictable debonding

## Genesis Active Self-Ligating Bracket System

- **Well-Polished surfaces** offers an attractive appearance
- **Rounded tie-wings and smooth ball-hooks** ensure patient comfort
- **Contoured 80-gauge mesh base** for true fit with the tooth and reliable bonding
- **Advanced technology Cobalt-Nickel clip** delivering provides reliable performance



## Wire Usage

### Passive Phase: Initial

Clip does not press on the wire allowing for less friction during early treatment.



### Transitional Phase: Intermediate

Clip lightly interacts with the wire allowing the bracket wire interface to control tooth movement.



### Active Phase: Finishing

Clip fully presses the wire into the bracket slot for precise finishing.



## Tool Usage



It's easy to open the brackets with the unique *Genesis-C* or *Genesis* Opening Tools.

## Opening Instructions

### To open the self-ligating bracket spring clip:

1. Place instrument on the open clip slot directly beneath the bracket interface and gently push in the occlusal direction to disengage the bracket clip.

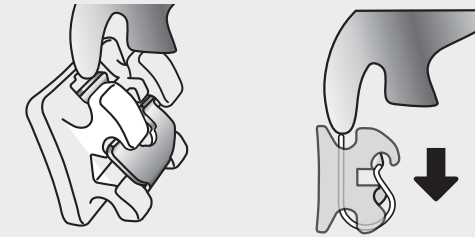

2. Then place the instrument directly in the facial opening of the clip to engage the small extension of the spring clip.

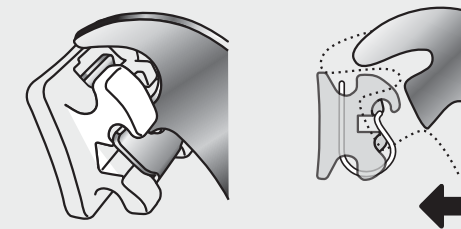

3. Pull in the occlusal direction. The spring clip will pop open. For added patient comfort, place a finger to support the tooth and this will act as a stop when opening.

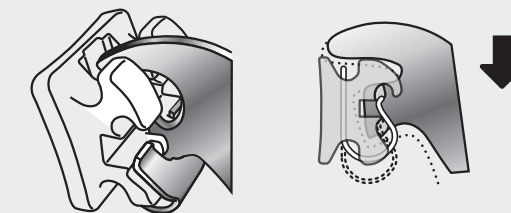

## Closing Instructions

Sedit, nest, nimusda et laccusa pienisti aut qui acesto tem et faci optatur?  
 Quias quae et plam, optatur eriaectem etur rempor magnatusam qui ad quam  
 quidus moluptas et aut enis dolor si sum fugiatest ut omnihicil estia aspero ma

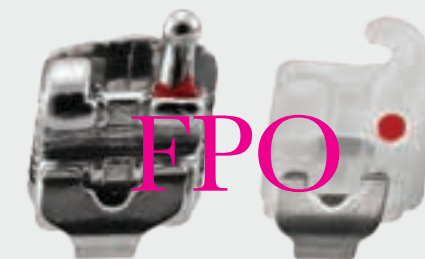



Ortho Organizers, Inc.  
1822 Aston Avenue  
Carlsbad, CA 92008  
U.S.A.  
MaselOrtho.com

## To Order by Phone

### Domestic

Ph 888.851.0533 760.448.8600  
Fax 800.888.7244 760.448.8602  
Email Sales@Masel.net

### International

Ph +(1) 760 448 8600  
Fax +(1) 760 448 8607  
Email Sales@Masel.net

### Canada

Ph +(1) 800 661 9567  
Fax +(1) 800 361 5088  
Email cerumsup@telusplanet.net

### Australia

Ph +1300 ORDERZ or +612 9540 6111  
Fax (02) 9524 7623 or +612 9524 7623  
Email sales@naol.com.au